

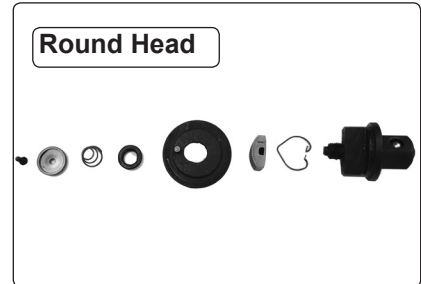

INSTRUCTIONS FOR:

RATCHET REPAIR KITS

The Sealey Ratchet Repair Kit that has been supplied to you will be one of the following three types:

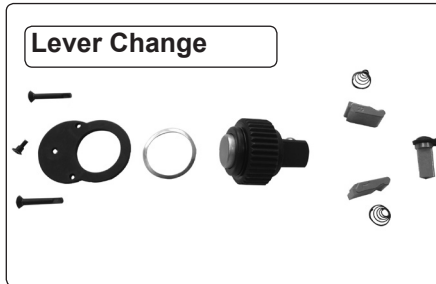
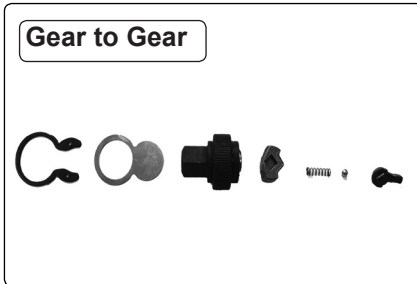

The head can be opened up to access the ratchet mechanism either by releasing the circlip using a pair of internal circlip pliers (fig.1) or removing the securing screws (figs. 2,3 & 4).



This will reveal:

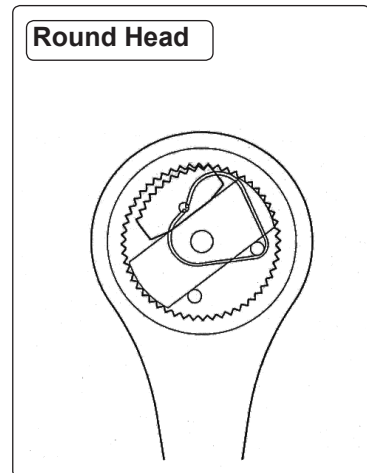
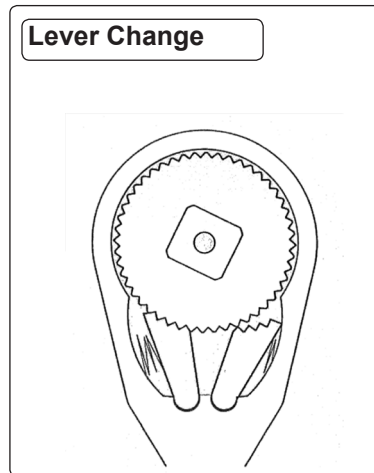
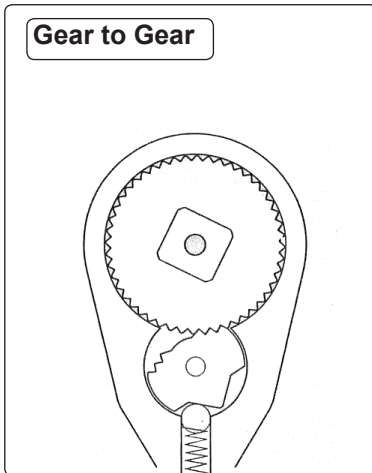

- Remove original components, noting carefully the order in which they were removed.
- Clean inside the ratchet head to remove any dirt or swarf and replace the components with the contents of the repair kit, ensuring that the original order is repeated.
- Please note that the ratchet pawls in the Lever Change kit are marked 'L' and 'R' and should be replaced in the same position as the originals.
- When rebuilding the Gear to Gear head, it may be useful to employ a pair of tweezers to hold the ball in place between the spring and pawl.
- With all internal components in place apply a small amount of grease, close the head back up and resecure.



Environmental Protection.
Recycle unwanted materials instead of disposing of them as waste. All tools, accessories and packaging should be sorted, taken to a recycling centre and disposed of in a manner which is compatible with the environment.



Sole UK Distributor, Sealey Group,
Kempson Way, Suffolk Business Park,
Bury St. Edmunds, Suffolk, IP32 7AR

01284 757500

01284 703534



www.sealey.co.uk



sales@sealey.co.uk