



310ML 20V SV20 SERIES CORDLESS CAULKING GUN - BODY ONLY

MODEL NO: CP20VCG

Thank you for purchasing a Sealey product. Manufactured to a high standard, this product will, if used according to these instructions, and properly maintained, give you years of trouble free performance.

IMPORTANT: PLEASE READ THESE INSTRUCTIONS CAREFULLY. NOTE THE SAFE OPERATIONAL REQUIREMENTS, WARNINGS & CAUTIONS. USE THE PRODUCT CORRECTLY AND WITH CARE FOR THE PURPOSE FOR WHICH IT IS INTENDED. FAILURE TO DO SO MAY CAUSE DAMAGE AND/OR PERSONAL INJURY AND WILL INVALIDATE THE WARRANTY. KEEP THESE INSTRUCTIONS SAFE FOR FUTURE USE.



Refer to instructions



Wear eye protection



Wear protective gloves



Wear ear protection

1. SAFETY

1.1. GENERAL POWER TOOL SAFETY WARNINGS

WARNING! Read all safety warnings and all instructions. Failure to follow the warnings and instructions may result in electric shock, fire and/or serious injury.

✓ Save all warnings and instructions for future reference.

1.1.1. WORK AREA SAFETY

✓ Keep work area clean and well lit. Cluttered or dark areas invite accidents.

✓ Evaluate your working area before using the tool; e.g. ceilings, floors and enclosures may contain electrical items or water piping.

✗ **DO NOT** operate power tools in explosive atmospheres, such as in the presence of flammable liquids, gases or dust. Power tools create sparks which may ignite the dust or fumes.

✓ Keep children and bystanders away while operating a power tool. Distractions can cause you to lose control.

1.1.2. PERSONAL SAFETY

✓ Stay alert, watch what you are doing and use common sense when operating a power tool. **DO NOT** use a power tool while you are tired or under the influence of drugs, alcohol or medication. A moment of inattention while operating power tools may result in serious personal injury.

✓ Use personal protective equipment. Always wear eye protection. Protective equipment such as dust mask, non-skid safety shoes, hard hat, or hearing protection used for appropriate conditions will reduce personal injuries.

✓ Prevent unintentional starting. Ensure the switch is in the off-position before connecting to power source and/or battery pack, picking up or carrying the tool.

✓ Carrying power tools with your finger on the switch or energising power tools that have the switch on invites accidents.

✓ Remove any adjusting key or wrench before turning the power tool on.

✗ **DO NOT** overreach. Keep proper footing and balance at all times. This enables better control of the power tool in unexpected situations.

✓ Dress properly. **DO NOT** wear loose clothing or jewellery. Keep your hair, clothing and gloves away from moving parts. Loose clothes, jewellery or long hair can be caught in moving parts.

✓ If devices are provided for the connection of dust extraction and collection facilities, ensure these are connected and properly used.

1.1.3. POWER TOOL USE AND CARE

✗ **DO NOT** force the power tool. Use the correct power tool for your application. The correct power tool will do the job better and safer at the rate for which it was designed.

✗ **DO NOT** use the power tool if the switch does not turn it on and off. Any power tool that cannot be controlled with the switch is dangerous and must be repaired.

WARNING! Disconnect the battery pack from the power tool before making any adjustments, changing accessories, or storing power tools.

✓ Store idle power tools out of the reach of children and do not allow persons unfamiliar with the power tool or these instructions to operate the power tool. Power tools are dangerous in the hands of untrained users.

✓ Maintain power tools. Check for misalignment or binding of moving parts, breakage of parts and any other condition that may affect the power tool's operation. If damaged, have the power tool repaired before use. Many accidents are caused by poorly maintained power tools.

✓ Use the power tool, accessories and tool bits etc. in accordance with these instructions, taking into account the working conditions and the work to be performed. Use of the power tool for operations different from those intended could result in a hazardous situation.

1.1.4. SERVICE

✓ Have your power tool serviced by a qualified repair person using only identical replacement parts. This will ensure that the safety of the power tool is maintained.

1.2. SPECIFIC CORDLESS CAULKING GUN SAFETY INSTRUCTIONS

✓ Keep hands and clothes away from the rod and plunger area, otherwise there is a risk of pinching.

✓ Hold tool firmly.

✓ Always work in a well ventilated area, wearing correct PPE for the task in hand.

✓ Read and follow manufacturer's instructions on caulking material/adhesive before use.

2. INTRODUCTION

Cordless 20V Caulking gun with cartridge holder. 6-Speed variable setting optimises the flow rate aiding precision. Suitable for 310ml cartridges. Cordless operation allows the gun to be used anywhere in workshops and homes. Composite housing with soft grip for added comfort. Requires compatible 20V battery and mains charger, sold separately.

3. SPECIFICATION

Model No. CP20VCG
Flow rate from: 0.7-11mm/s
Noise Power/Noise Pressure: 70/60dB(A)
Vibration/Uncertainty: 1.016/1.5m/s²
Max Dispensing Force: 4500Nm

4. OPERATION

4.1. FIT BATTERY

- ❑ **WARNING!** Always ensure tool is switched off and battery removed before adjusting or checking function of the tool.
- ❑ **WARNING!** Always ensure tool is switched off before fitting or removing battery.

- 4.1.1. Install: align tongue on battery with groove in housing and slide until it locks into place.
4.1.2. Remove: press button in on front of battery, slide off the battery.

4.2. BATTERY PROTECTION SYSTEM

- 4.2.1. The tool automatically cuts off power to the motor to extend battery life. The tool will stop if:
Overloaded (operated in a manner to cause it to draw an abnormally high current. turn the tool off and stop the process which caused the tool to become overloaded. Turn tool on to restart. If tool does not start allow battery time to cool down.
Overheated When the tool/battery is overheated, the tool stops automatically. In this situation, let the tool/battery cool before turning the tool on again.
Overdischarge protection The remaining battery capacity is too low and the tool will not operate. If you turn the tool on, the motor runs again but stops soon. In this situation, remove and recharge the battery.

4.3. SWITCH ON/OFF fig.1

- 4.3.1. To prevent the switch trigger fig.1.1 from accidentally pulled, the trigger-lock button fig.1.2 is provided. To start the tool, depress the trigger-lock button and pull the switch trigger. Tool speed is increased by increasing pressure on the switch trigger. Release the switch trigger to stop. After use, press in the trigger-lock button.

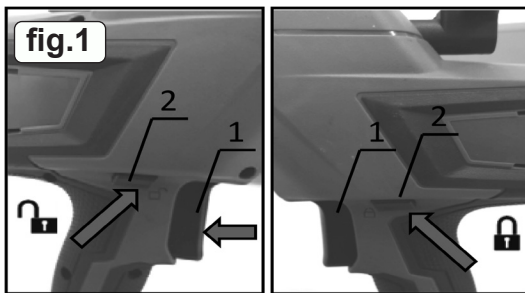

4.4. SPEED ADJUSTING DIAL fig.2.1

- 4.4.1. The tool speed can be adjusted by turning the speed adjusting dial. Highest speed is 6 and the lowest speed is 1.
NOTE: DO NOT Turn the dial quickly when the tool is working.
NOTE: Depending on the type and conditions of caulking material, it may not be fed at low speed, or feed too fast at the higher speed. In this case, set the speed adjusting dial according to the material being used.
NOTE: When changing the speed dial from "5" to "1", turn the dial counterclockwise. **DO NOT** turn the dial clockwise forcibly.

4.5. DRIP PREVENTION FUNCTION

The motor keeps running for a short time even after the trigger is released. It releases the pressure of the caulking material and prevents dripping.

5. ASSEMBLY

- ❑ **WARNING!** Make sure tool is switched off and battery pack is removed before carrying out any work on the tool.

5.1. INSTAL/REMOVE CARTRIDGE HOLDER

- 5.1.1. Attach the washer, holder joint and plate onto the base by securing the screws firmly in order. To remove the holder joint, follow the installation procedure in reverse.

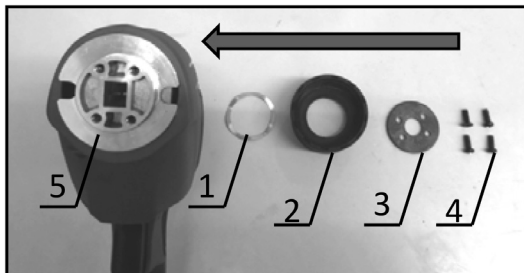

fig.3

- 1 Washer
- 2 Holder joint
- 3 Plate
- 4 screw
- 5 Base

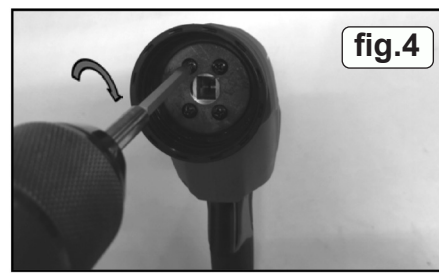
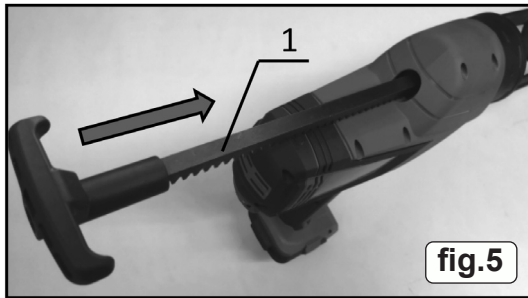

fig.4

5.2. INSTALLING/REMOVING ROD AND PISTON



- 5.2.1. Insert the rod fig.5.1 from the rear of the tool with teeth facing downwards.
5.2.2. Attach the piston fig.6.2 with the screw fig.7.3

5.3. INSTALLING/REMOVING HOLDER

- 5.3.1. Secure holder fig.8.1 to holder joint firmly, otherwise the holder may come off in use and cause an injury.
5.3.2. To install the holder, turn it clockwise firmly until it stops while holding the holder joint. To remove the holder, follow the installation procedure in reverse.

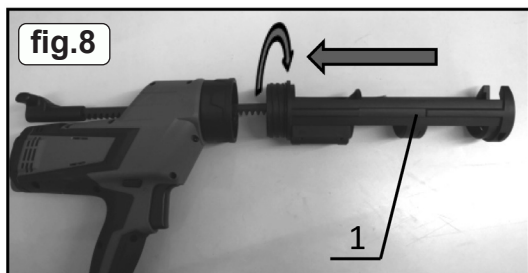
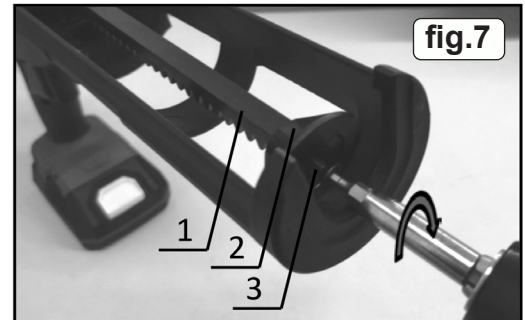
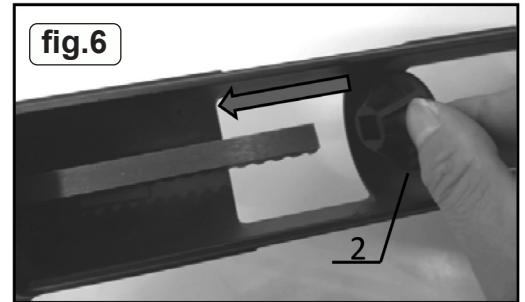

6. OPERATION

- WARNING:** Always disconnect the battery before carrying out any adjustment, inspection, maintenance or cleaning.

6.1. PREPARE CARTRIDGE

- 6.1.1. Cut tip of cartridge, pierce protective film and attach nozzle.

NOTE: Check cartridge for damage before use.

NOTE: When reusing a partially used cartridge remove solid caulking material in cartridge before using.

6.2. INSTALL CARTRIDGE

NOTE: Make sure piston fig.9.1 is attached to the rod. **DO NOT** use any other type of piston.

- 6.2.1. Pull the piston rod handle slowly backwards until it stops.

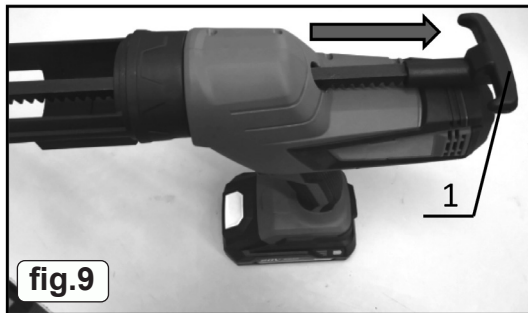

- 6.2.2. Insert cartridge fig.10.

6.3. CAULKING

- 6.3.1. Pull the trigger to feed the caulking material. Put one hand under the holder to support the tool while operating it. After the operation, wipe off the caulking material from the tool. Be sure to remove the caulking material before it becomes solid.

NOTE: At the beginning of operation, set the speed adjusting dial to "1" and pull the switch trigger slowly to check how much amount of caulking material is fed.

NOTE: Depending on the type and conditions of caulking material, it may not be fed at low speed. In this case, set the speed adjusting dial higher.

NOTE: If the caulking material is not fed, check the following points:

- The tip of cartridge nozzle is not cut adequately.
- The caulking material is solid and clogged in the nozzle.
- The cartridge is damaged.
- The caulking material is stiff. Warm the material until it becomes soft.
- The attached piston is not suitable for the type of caulking material.

7. MAINTENANCE

- WARNING:** Always disconnect the battery before carrying out any adjustment, inspection, maintenance or cleaning.

NOTE: Never use gasoline, benzene, thinner, alcohol or the like. Discoloration, deformation or cracks may result.

- 7.1. Professional repair only. Contact Sealey stockist for assistance with repairs.

- 7.2. Only use genuine spare parts.

WARNING! – Risk of Hand Arm Vibration Injury.

This tool may cause Hand Arm Vibration Syndrome if its use is not managed adequately.

This tool is subject to the vibration testing section of the Machinery Directive 2006/42/EC.

This tool is to be operated in accordance with these instructions.

Measured vibration emission value (a): 1.016m/s²

Uncertainty value (k): 1.5m/s²

Please note that the application of the tool to a sole specialist task may produce a different average vibration emission. We recommend that a specific evaluation of the vibration emission is conducted prior to commencing with a specialist task.

A health and safety assessment by the user (or employer) will need to be carried out to determine the suitable duration of use for each tool.

NB: Stated Vibration Emission values are type-test values and are intended to be typical.

Whilst in use, the actual value will vary considerably from and depend on many factors.

Such factors include; the operator, the task and the inserted tool or consumable.

NB: ensure that the length of leader hoses is sufficient to allow unrestricted use, as this also helps to reduce vibration.

The state of maintenance of the tool itself is also an important factor, a poorly maintained tool will also increase the risk of Hand Arm Vibration Syndrome.

Health surveillance.

We recommend a programme of health surveillance to detect early symptoms of vibration injury so that management procedures can be modified accordingly.

Personal protective equipment.

We are not aware of any personal protective equipment (PPE) that provides protection against vibration injury that may result from the uncontrolled use of this tool. We recommend a sufficient supply of clothing (including gloves) to enable the operator to remain warm and dry and maintain good blood circulation in fingers etc.

Please note that the most effective protection is prevention, please refer to the Correct Use and Maintenance section in these instructions. Guidance relating to the management of hand arm vibration can be found on the HSE website www.hse.gov.uk - Hand-Arm Vibration at Work.



ENVIRONMENT PROTECTION

Recycle unwanted materials instead of disposing of them as waste. All tools, accessories and packaging should be sorted, taken to a recycling centre and disposed of in a manner which is compatible with the environment. When the product becomes completely unserviceable and requires disposal, drain any fluids (if applicable) into approved containers and dispose of the product and fluids according to local regulations.



WEEE REGULATIONS

Dispose of this product at the end of its working life in compliance with the EU Directive on Waste Electrical and Electronic Equipment (WEEE). When the product is no longer required, it must be disposed of in an environmentally protective way. Contact your local solid waste authority for recycling information.

Note: It is our policy to continually improve products and as such we reserve the right to alter data, specifications and component parts without prior notice.

Important: No Liability is accepted for incorrect use of this product.

Warranty: Guarantee is 12 months labour and two years parts warranty from purchase date, proof of which is required for any claim.



Sealey Group, Kempson Way, Suffolk Business Park, Bury St Edmunds, Suffolk. IP32 7AR



01284 757500



01284 703534



sales@sealey.co.uk



www.sealey.co.uk