

SEALEY

50L MOBILE PARTS CLEANING TANK

MODEL NO: SM28.V2

Thank you for purchasing a Sealey product. Manufactured to a high standard, this product will, if used according to these instructions, and properly maintained, give you years of trouble free performance.

IMPORTANT: PLEASE READ THESE INSTRUCTIONS CAREFULLY. NOTE THE SAFE OPERATIONAL REQUIREMENTS, WARNINGS & CAUTIONS. USE THE PRODUCT CORRECTLY AND WITH CARE FOR THE PURPOSE FOR WHICH IT IS INTENDED. FAILURE TO DO SO MAY CAUSE DAMAGE AND/OR PERSONAL INJURY AND WILL INVALIDATE THE WARRANTY. KEEP THESE INSTRUCTIONS SAFE FOR FUTURE USE.



Refer to instructions



Wear eye protection



Wear protective gloves



Wear safety footwear



Wear protective clothing

1. SAFETY

1.1. ELECTRICAL SAFETY

- ❑ **WARNING!** It is the user's responsibility to check the following:
Check all electrical equipment and appliances to ensure that they are safe before using. Inspect power supply leads, plugs and all electrical connections for wear and damage. Sealey recommend that an RCD (Residual Current Device) is used with all electrical products. You may obtain an RCD by contacting your local Sealey stockist.
If the product is used in the course of business duties, it must be maintained in a safe condition and routinely PAT (Portable Appliance Test) tested.

Electrical safety information, it is important that the following information is read and understood:

Ensure that the insulation on all cables and on the appliance is safe before connecting it to the power supply.

Regularly inspect power supply cables and plugs for wear or damage and check all connections to ensure that they are secure.

Important: Ensure that the voltage rating on the appliance suits the power supply to be used and that the plug is fitted with the correct fuse - see fuse rating in these instructions.

- ✗ **DO NOT** pull or carry the appliance by the power cable.
- ✗ **DO NOT** pull the plug from the socket by the cable.
- ✗ **DO NOT** use worn or damaged cables, plugs or connectors. Ensure that any faulty item is repaired or is replaced immediately by a qualified electrician.

This product is fitted with a BS1363/A 13 Amp 3 pin plug.

If the cable or plug is damaged during use, switch off the electricity supply and remove from use.

Ensure that repairs are carried out by a qualified electrician.

Replace a damaged plug with a BS1363/A 13 Amp 3 pin plug. If in doubt contact a qualified electrician.

a) Connect the GREEN/YELLOW earth wire to the earth terminal 'E'.

b) Connect the BROWN live wire to the live terminal 'L'.

c) Connect the BLUE neutral wire to the neutral terminal 'N'.

Ensure that the cable outer sheath extends inside the cable restraint and that the restraint is tight.

Sealey recommend that repairs are carried out by a qualified electrician.

Cable extension reels. When a cable extension reel is used it should be fully unwound before connection. A

cable reel with an RCD fitted is recommended since any product which is plugged into the cable reel will be protected. The section of the cores of the cable is important and should be at least 1.5mm², but to be absolutely sure that the capacity of the cable reel is suitable for this product and for others that may be used in the other output sockets, we recommend the use of 2.5mm² section cable.

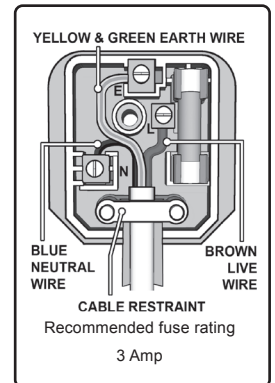

1.2. GENERAL SAFETY

- ❑ **WARNING!** *Ensure Health & Safety, local authority, and general workshop practice regulations are adhered to when using this equipment.*
- ✓ Familiarise yourself with the applications, limitations and potential hazards of the tank.
- ❑ **WARNING!** Disconnect the tank from the mains power before changing accessories, servicing or performing any maintenance.
- ✓ Replace or repair damaged parts. *Use genuine parts only. Unauthorised parts may be dangerous and will invalidate the warranty.*
- ❑ **WARNING! DO NOT** modify the lid or jam it open. Keep the lid and holding screws in place, tight and in good working order.
- ✓ Locate tank in a suitable work area and keep area clean and tidy and free from unrelated materials. Ensure there is adequate lighting.
- ✓ Ensure there are no flammable or combustible materials near the work area.
- ✓ In case of fire in tank, **DO NOT** attempt to move unit or remove parts from tank. The lid is fusible and will automatically close extinguishing fire.
- ✓ **When cleaning parts ensure that nothing in the tank, including any parts basket, is in a position that would prevent the lid from closing fully if and when the fusible link activates.**
- ❑ **WARNING! DO NOT SMOKE** and keep sources of ignition, such as heaters, lamps, etc., away from the unit, together with flammable or combustible materials, as there is an explosion risk.
- ✓ Use only water soluble solvent.
- ❑ **WARNING!** When operating the tank always wear approved eye or face protection and appropriate protective clothing, including gloves, to prevent the cleaning agent contacting the skin.
- ✓ Maintain correct balance and footing. **DO NOT** overreach. Ensure the floor is not slippery and wear non-slip shoes.
- ✓ Remove ill fitting clothing. Remove ties, watches, rings, and other loose jewellery and contain and/or tie back long hair.
- ✓ ALWAYS concentrate on the job in hand, no matter how trivial it may seem. Be aware that accidents are caused by carelessness due to familiarity.
- ✓ Keep children and unauthorised persons away from the work area.

- ✓ Avoid unintentional starting. Ensure the switch is in the off position before plugging into mains supply.
- ✗ **DO NOT** overfill tank or allow fluid level to fall below pump inlet.
- ✗ **DO NOT** use the tank for a task it is not designed to perform.
- ✗ **DO NOT** operate the tank if any parts are damaged or missing as this may cause failure and/or personal injury.
- ✗ **DO NOT** allow untrained persons to operate the tank.
- ✗ **DO NOT** operate the tank when you are tired or under the influence of alcohol, drugs or intoxicating medication.
- ✗ **DO NOT** leave the tank operating unattended.
- ✓ When not in use switch off the tank, close the lid and remove the plug from the power supply.
- ✓ Dispose of waste liquids in accordance with local authority regulations.
- ☐ **WARNING!** Protect the environment - **DO NOT** allow uncontrolled discharge of pollutants.
- ✓ Keep the tank clean for best and safest performance.

2. INTRODUCTION

Heavy-duty one-piece tank. Fully sealed electric motor with magnetic drive pump unit. Lid features self-latching fusible link which automatically snaps lid shut in the event of a fire. Includes removable shelf and small parts basket. Flexible metal nozzle directs solvent over work. Supplied with workshop stand with integral storage shelf.

3. SPECIFICATION

Model no SM28.V2
 Maximum Working Capacity:..... 50L
 Minimum working Capacity: 40L
 Overall Dimensions (W x D x H):..... 775 x 540 x 960mm
 Pump Output/hr:..... 200L
 Supply:..... 230V
 Tank Dimensions (W x D x H): 775 x 540 x 265mm

4. ASSEMBLY

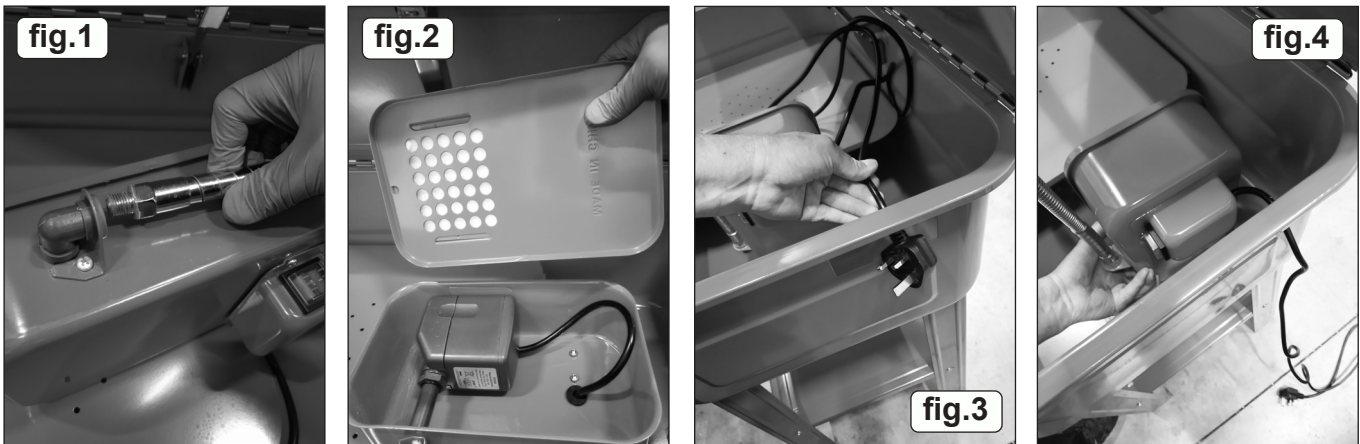

- 4.1. Refer to attached Parts Diagram.
- 4.2. Remove parts from packing and take items out of the tank. Before assembly check parts to ensure they are complete and not damaged.
- 4.3. Close lid of tank, gently and turn unit upside down. *Rest tank on a clean soft surface (i.e. cardboard) ensuring lid is secured in the closed position.*
- 4.4. Attach each of the 4 tank legs (13) with 4 sets each of 6mm screws, lockwashers and nuts (14,8,9) to the brackets on the tank (7) unit.
- 4.5. Attach shelf (12) to holes located mid-way of 4 legs with 2 sets each of 6mm screws, lockwashers and nuts (14,8,9).
- 4.6. Fit swivel castors, (37, 38) using nut and washer (40, 39).
- 4.7. Return the tank unit to the upright position on its legs and open the spring tensioned tank cover (1).
- 4.8. Thread the fitting of the flexible metal pipe (24) fluid outlet tube onto the pump elbow (13), fig.1. Place the pump housing lid (29) over the open pump housing (20) with fluid intake perforations and raised ribs downward and over pump fig.2. Snap into place.
- 4.9. Route the power cord of the pump housing assembly through the rectangular opening on the side of the tank unit (7) with the inlet filter (28) downward and facing inward, fig's.3 & 4.
- 4.10. The power switch is visible through the rectangular opening. Hook the raised offset tab on the rear of the pump housing (20) over the bottom edge of the rectangular opening fig.4.
- 4.11. Check to see that the tank plug (11) plug is tightly installed.
- 4.12. Place the work shelf (6) over the edges on the walls of the tank (7).
- 4.13. Make sure the nozzle of the flexible pipe (24) is facing in toward the centre of the tank (7) and downward.
- 4.14. Installation of a flow-through parts cleaning brush and hose extension is optional.
- 4.15. Fill unit with suitable, water-based degreasing solution sufficiently to cover the entire inlet filter (28) (approx. 12 gallons).
 Important Note: Follow degreasing solution mixing, usage and safety label instructions carefully before using.
- 4.16. Plug power lead into mains supply.
- 4.17. Turn Power Switch to the "On" position.

5. OPERATION

- ☐ **WARNING! Wear safety clothing, eye protection and gloves and ensure you read, understand and apply the safety instructions in Section 1.**
- 5.1. Ensure the unit is located on a firm level surface in a well ventilated area and is switched off and unplugged from the mains power supply.
 - 5.2. Fill the tank with Sealey solvent - approx. 50 litres. Minimum level **must** cover pump inlet - approx. 40 litres. Follow the solvent instructions on the packaging.

- × **DO NOT** fill with flammable solvents such as paraffin, thinners, etc.
- 5.3. Open the lid, switch the pump on and hold the part to be cleaned under the nozzle, slowly rotate the component until clean.
- × **DO NOT** leave the unit operating unattended.
- 5.4. When clean, leave to drain on the tray or in a small component container until dry.
When cleaning is complete remove all parts whilst ensuring the minimum of cleaning agent spillage.
- 5.5. Switch off the pump and close the lid and disconnect the power supply.
Note: Any spillages should be mopped up immediately, so as not to cause a safety hazard. Dispose of waste liquids in accordance with local authority regulations.
IMPORTANT: The safety lever (4,5) incorporates a safety device in the form of a fusible link, which closes the lid in the event of fire. The link is non-resetting and must be replaced should it be activated.
- × **DO NOT prop the lid open as this will prevent the automatic safety feature from operating.**
- 5.6. When cleaning parts ensure that nothing in the tank, including any parts basket, is in a position that would prevent the lid from closing fully if and when the fusible link activates.

6. MAINTENANCE

- 6.1. Clean the pump filter regularly, by sliding it away from the pump housing and rinsing it in clean degreaser.
- × **DO NOT** allow the level of liquid in the parts washer to fall below the pump inlet, as damage to the pump can result.



WEEE REGULATIONS

Dispose of this product at the end of its working life in compliance with the EU Directive on Waste Electrical and Electronic Equipment (WEEE). When the product is no longer required, it must be disposed of in an environmentally protective way. Contact your local solid waste authority for recycling information.



ENVIRONMENT PROTECTION

Recycle unwanted materials instead of disposing of them as waste. All tools, accessories and packaging should be sorted, taken to a recycling centre and disposed of in a manner which is compatible with the environment. When the product becomes completely unserviceable and requires disposal, drain any fluids (if applicable) into approved containers and dispose of the product and fluids according to local regulations.

Note: It is our policy to continually improve products and as such we reserve the right to alter data, specifications and component parts without prior notice. Please note that other versions of this product are available. If you require documentation for alternative versions, please email or call our technical team on technical@sealey.co.uk or 01284 757505.

Important: No Liability is accepted for incorrect use of this product.

Warranty: Guarantee is 12 months from purchase date, proof of which is required for any claim.

Sealey Group, Kempson Way, Suffolk Business Park, Bury St Edmunds, Suffolk. IP32 7AR



01284 757500



01284 703534



sales@sealey.co.uk



www.sealey.co.uk